

# LARGE FORMAT SWING-DOWN PANEL SYSTEM ON BOTH SIDES

ORIAL XL  
[ PLAFOMETAL-CC-130 ]

## General view - underneath and above

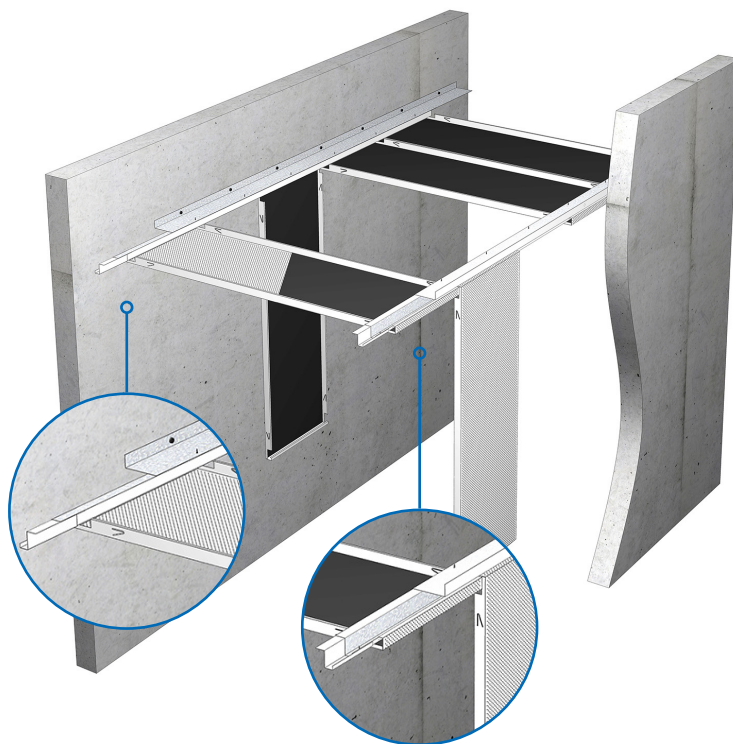
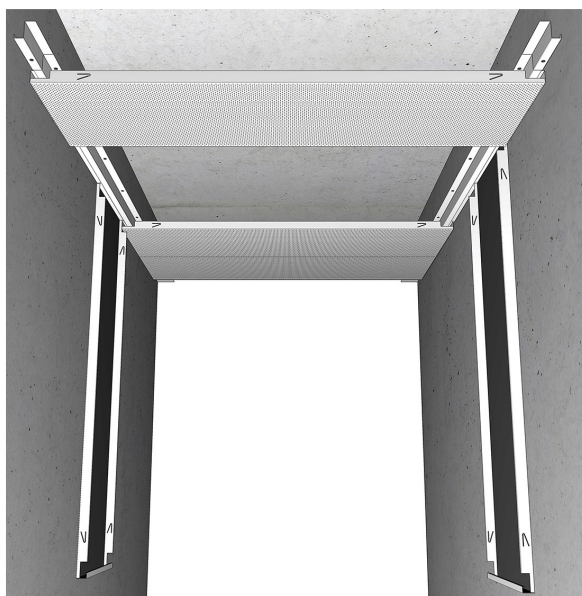

These visuals are available in greater detail  
on our web site in the "System visuals" section

## Description

- Opening swing-down ceiling for corridors.
- Panel laid on an invisible profile with offset edge forming a closed hollow joint between the end of the panels and the wall.
- Inward folds allow the panel to be suspended on the grid and swung down from either side.
- Block of wool fitted on the sides of the panel to keep the additional acoustic component in place.

## Intended use

**Ideal for:** corridors in office buildings and hospitals.

## Sectional view showing space requirements

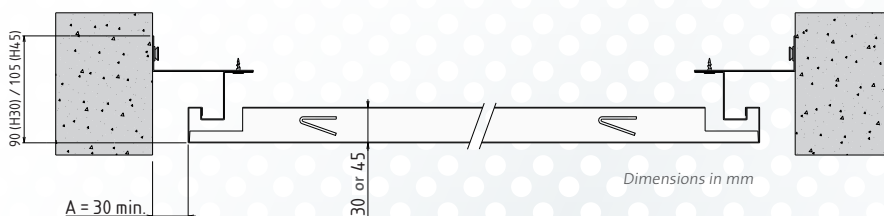

A gap A is required between the panel and the wall

# LARGE FORMAT SWING-DOWN PANEL SYSTEM ON BOTH SIDES

ORIAL XL  
[ PLAFOMETAL-CC-130 ]

## KEY FEATURES

- **Opening:** swing-down on both sides and robust
- **Aesthetics:** large panel

- **Aesthetics:** grid with an offset edge for a perfectly straight finish

- **Acoustics:** high degree of correction, absorption factor  $\alpha_w$  up to 1

| SYSTEM INFORMATION |                                      |                    |          |   |   |
|--------------------|--------------------------------------|--------------------|----------|---|---|
| Component          |                                      | Dimensions (mm)    |          |   | Material                                    |
|                    |                                      | Width              | Height   | Length                                    |   |
|                    | Oriol XL Plafometal* panel           | 300                | 30 or 45 | Made to order                             | Galvanized steel<br>thickness 0.6 to 0.8 mm |
|                    |                                      | 400                |          | Recommended dimension:<br>between 800 and |   |
|                    |                                      | 600                |          | 2,500 mm depending                        |   |
|                    |                                      | 675                |          | on self-supporting capacity*              |   |
|                    | Additional acoustic component        | according to panel |          |   | see ALPHA and ALPHA PLUS offer              |
|                    | Oriol XL Plafometal wall angle       | 30x85 Lg. 3000     |          |   | Steel thickness 1 mm                        |
|                    | Oriol XL Plafometal profile          | Lg. 3000           |          |   | Steel thickness 1 mm                        |
|                    | Oriol XL Plafometal length connector | -                  |          |   | -   |

\* Refer to the product information sheet

**Acoustics**  
According to standard EN ISO 11 654  
 $\alpha_w$  up to 0.85 with the ALPHA offer  
 $\alpha_w$  up to 1 with the ALPHA PLUS offer  
Acoustic performance depends on the chosen perforations

**Light reflection**  
Up to 87%

**EPD verified**  
Available on the INIES database ([www.inies.fr](http://www.inies.fr))

**Opening**  
Push up then move sideways to avoid the hook-on profile. The panel swings down and remains hooked onto the opposite profile.  
Put the panel back in place in reverse order, ensuring that all the elements are aligned. The wool blocks prevent the additional acoustic components from sliding.

**Reaction to fire**  
According to standard EN 13501-1  
Euroclass A1 for these products:  
• pre-painted non-perforated  
• pre-painted in the ALPHA offer  
Euroclass A2 s1,d0 for these products:  
• post-lacquered non-perforated  
• post-lacquered in the ALPHA offer  
• in the ALPHA PLUS offer

**Cut-outs and integration**  
Factory cut-outs on request

**Indoor air quality**  
Class A+ for all these products:  
• non-perforated  
• in the ALPHA offer  
• in the ALPHA PLUS offer, with specific mineral wool pad in thin plastic film  
Class A for all the products in the ALPHA PLUS offer, with specific mineral wool pad with black tissue face

**Additional acoustic component**  
ALPHA offer: Plafometal acoustic fleece  
ALPHA PLUS offer: specific mineral wool pas with black tissue face or in thin plastic film

**Perforations**  
Open area percentage, diameter in mm and M or U layout

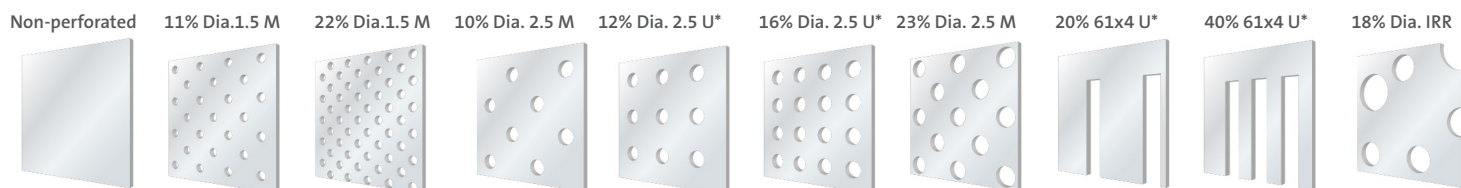

Perforations can be stopped at the end of the panel (except for 18% IRR).  
\* Only available with perforations stopped on all 4 sides.

**Colors**  
White 137 (≈ RAL 9003) - Pre-painted polyester  
Metallic Gray (RAL 9006) - Pre-painted polyester - on request  
180 RAL colors on request - Polyester powder coating