

# FIRE-RESISTANT SWING-DOWN PANEL SYSTEM ON BOTH SIDES

ORIAL SF  
[ PLAFOMETAL-CC-120 ]

## General view - underneath and above

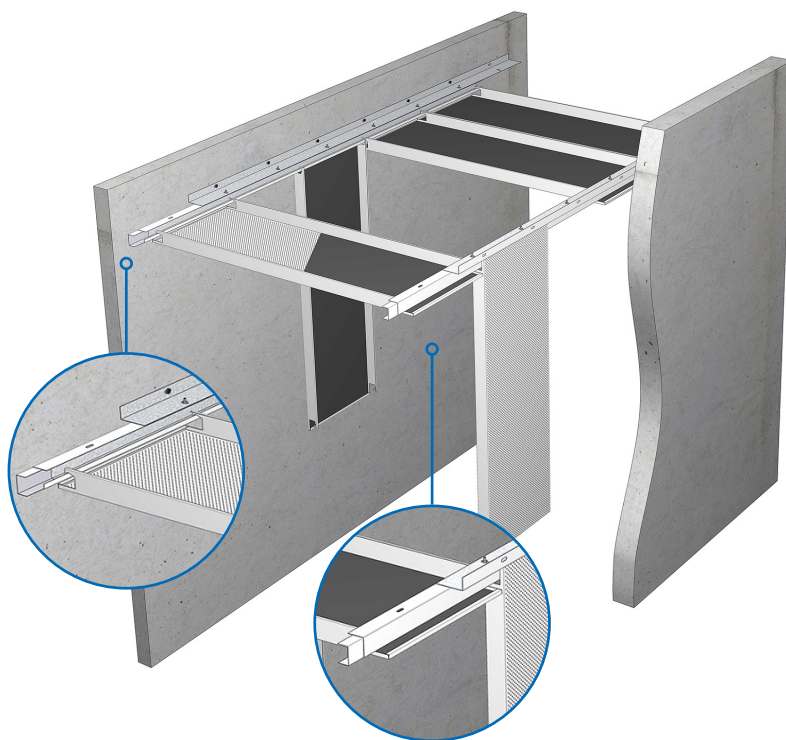
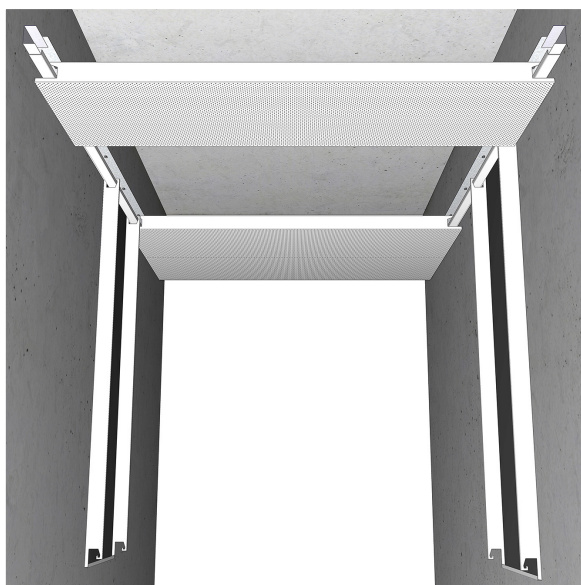

These visuals are available in greater detail  
on our web site in the "System visuals" section

## Description

- Opening swing-down ceiling, 1/2-hour fire-resistance, designed for communal corridors in high-rise buildings.
- Panel laid on an invisible profile with offset edge forming an open hollow joint between the end of the panels and the wall. This profile has oblong holes.
- Notches allow the panel to be suspended on the grid and swung down from either side.

## Intended use

**Ideal for:** corridors that need to be fire-resistant.

## Sectional view showing space requirements

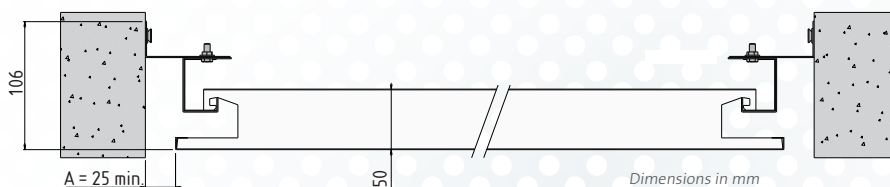

A gap A is required between the panel and the wall

# FIRE-RESISTANT SWING-DOWN PANEL SYSTEM ON BOTH SIDES

ORIAL SF  
[ PLAFOMETAL-CC-120 ]



## KEY FEATURES

- **Opening:** swing-down on both sides
- **Acoustics:** absorption factor  $\alpha_w$  up to 0.80

- **Safety:** 1/2-hour fire resistance (French regulations)
- **Aesthetics:** grid with an offset edge for a perfectly straight finish

- **Ventilation of the plenum:** open hollow joint, suitable for hospitals

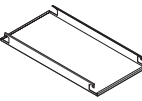
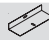
### SYSTEM INFORMATION

ORIAL SF PLAFOMETAL*					
Component		Dimensions (mm)			Material
		Width	Height	Length	
	Oriaf SF Plafometal* panel	300	50	Made to order	Galvanized steel thickness 0.6 to 0.8 mm
		400		Recommended dimension: between 800 and 1,500 mm depending on max. specified in the fire classification report*	
		600			
	Additional acoustic component	according to panel			see the ALPHA offer
	Oriaf SF Plafometal wall angle	30x70 Lg. 3000			Steel thickness 1 mm
	Oriaf SF Plafometal profile	Lg. 3000			Steel thickness 1 mm
	Oriaf Plafometal length connector	-			-

\* Refer to the product information sheet

 **Acoustics**  
According to standard EN ISO 11 654  
 $\alpha_w$  up to 0.80 with the ALPHA offer  
Acoustic performance depends on the chosen perforations

 **Light reflection**  
Up to 87%

 **EPD verified**  
Available on the INIES database  
([www.inies.fr](http://www.inies.fr))

 **Reaction to fire**  
According to standard EN 13501-1  
Euroclass A1 for these products:  
• pre-painted non-perforated  
• pre-painted in the ALPHA offer  
Euroclass A2 s1,d0 for these products:  
• post-lacquered non-perforated  
• post-lacquered with powder in the ALPHA offer

 **Cut-outs and integration**  
The ceiling should not support any loads other than its own weight. For further details, refer to the installation guide or contact us.

 **Indoor air quality**  
Class A+ for all these products:  
• non-perforated  
• in the ALPHA offer

 **Additional acoustic component**  
ALPHA offer: Plafometal acoustic fleece

 **Opening**  
Push up then move sideways to avoid the hook-on profile. The panel swings down and remains hooked onto the opposite profile. Put the panel back in place in reverse order, ensuring that all the elements are aligned.

 **Fire stability**  
**France:** Fire stability SF 1/2-hour according to the test described in the Order of March 22, 2004 annex 1 § 2.5 with regard to French fire regulations in the communal corridors of high-rise buildings. Implementation must comply with the classification report and extensions. Contact us.  
[Learn more about our 4 fire-resistant systems in the dedicated brochure](#)

 **Perforations**  
Open area percentage, diameter in mm and M or U layout

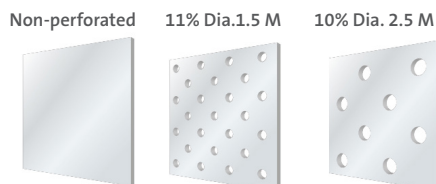

Perforations can be stopped at the end of the panel.  
Other perforations 12% Dia. 2.5 U and 20% Dia. 1.5 M available with 1/4-hour fire stability by extension.

 **Colors**  
White 137 (≈ RAL 9003) - Pre-painted polyester  
Metallic Gray (RAL 9006) - Pre-painted polyester - on request  
180 RAL colors on request - Polyester powder coating