

Acoustiroc®

METAL ACOUSTIC WALL PANEL

Edition 2



α_w up to 1



Proven impact
resistance



Wide aesthetic
choices

PLAFOMETAL

Discover the Acoustiroc® system!



In busy premises (schools, industrial facilities, etc.), it is essential to take into consideration the comfort of both their occupants and building owner.

Such types of establishments must reconcile several needs: acoustic correction, aesthetics, impact resistance and ease of maintenance and upkeep.

Plafometal offers a solution that addresses all these requirements: Acoustiroc® is an acoustic metal wall panel system made of perforated painted metal panels filled in with acoustic fleece and mineral wool, framed by aluminum profiles.

The Acoustiroc® system can be installed in any type of building and is particularly recommended:

- **in schools (canteens, corridors, gyms, etc.)**
- **in the lobbies and corridors of public-access buildings (hotels, restaurants, collective housing, etc.)**
- **in equipment rooms (industrial environment, room housing noisy equipment, etc.)**

Composition of the Acoustiroc® system

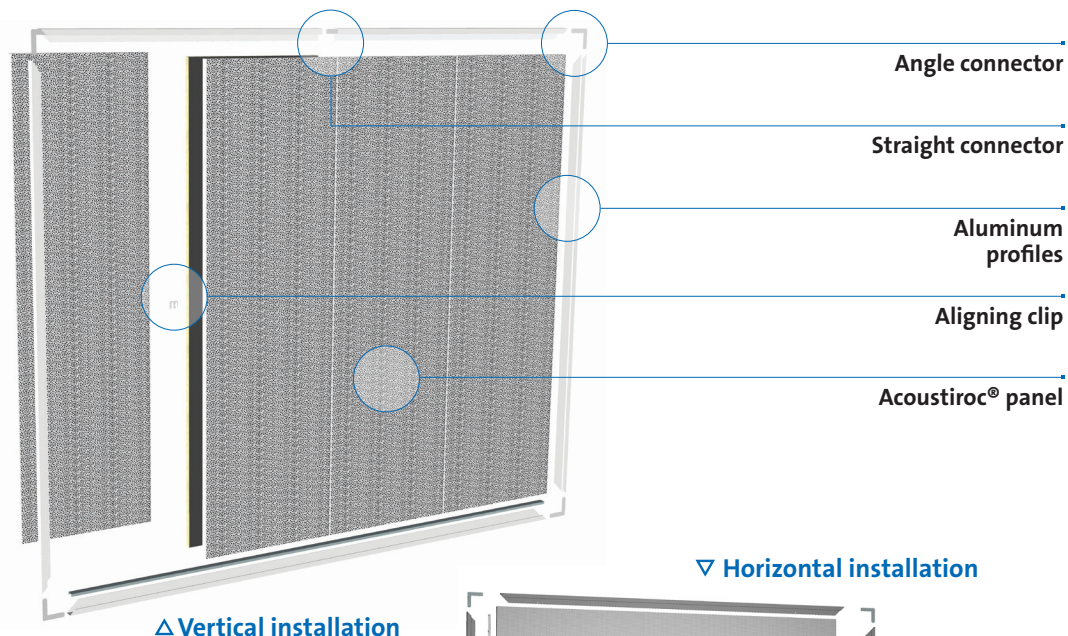

▽ Horizontal installation

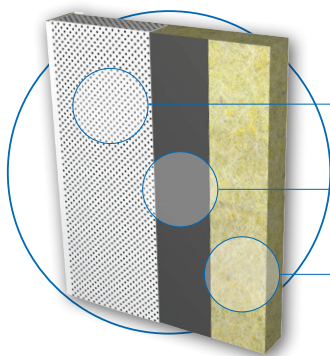
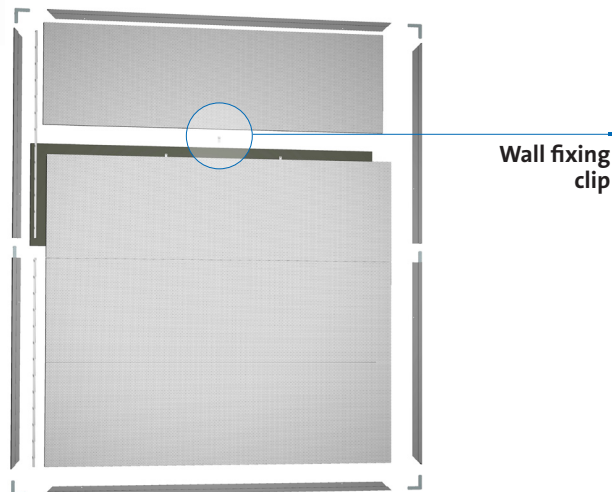

The +

■ High acoustic correction

High acoustic correction: α_w up to 1

■ Proven impact resistance

to various everyday objects (standard NF P08-301)

■ Wide aesthetic choices

3 perforations and a choice of 12 “Soft Touch” colors
Vertical or horizontal installation

■ Indoor Air Quality A and Finnish label M1

From procurement to life with the finished product, Acoustiroc® meets everyone's expectations



Building owners and project managers:

- Quick and easy work
- Clean work site
- Comfort and well-being for the occupants
- Comfort for the project manager: impact resistance, easy maintenance and cleaning

Specifiers:

- Easy solution to explain
- Effective and robust acoustic correction system
- Aesthetic: wide choice of modern colors and creative options
- Impact resistance

Installers:

- Quick and easy to install
- Easy to order, simple procurement process
- All-inclusive solution supplied in kit form
- Small quantities (minimum order: 1 package = 2 panels)

A solution for everyone's comfort!

Acoustics

- A good acoustical environment makes a place more comfortable but also more conducive to calmness, work, confidentiality...
- Capitalizing on its experience in acoustic metal ceilings, Plafometal has designed an extremely effective wall panel solution addressing the issue of acoustic correction. The perforated metal panels with suitable filling absorb sound energy and thereby offer the highest levels of sound absorption performance.

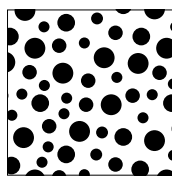

**Acoustiroc®
ORION**
25% Ø3 to 7
(round, irregular)
 $\alpha_w = 1$
NRC : 0,95

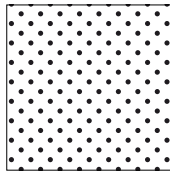

**Acoustiroc®
INFINITY**
11% Ø1,5
(round, regular)
 $\alpha_w = 0,95$
NRC : 0,90

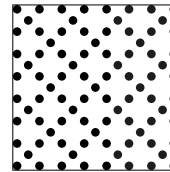

**Acoustiroc®
ASTRAL**
17% Ø2,5
(round, regular)
 $\alpha_w = 0,95$
NRC : 0,90

Aesthetics

- The colors influence perception and enhance the visual comfort and personality of the place. They create an atmosphere, structure the volumes and thereby make the interior of a building particularly vibrant.
- **The Acoustiroc® panel has been designed to give free rein to creativity, with:**
 - **3 perforations:**
 - **Acoustiroc® ORION:** brings a particularly creative result
 - **Acoustiroc® INFINITY:** ensures a very discreet rendering
 - **Acoustiroc® ASTRAL:** introduces a touch of originality

As the perforation is continuous over the height, these perforations are randomly aligned from one panel to the next; this does not interfere with the overall visual rendering once the panels have been installed.

■ **A range of 12 modern colors**, drawing their inspiration from current trends, with a high-end “Soft Touch” finish. These colors can be combined with one another to create countless combinations, for totally customized projects.

■ **2 installations options**, vertical or horizontal

Impact resistance

- **The Acoustiroc® panels** have been tested according to standard NF P 08-301.
 - Soft body impact test (50 kg bag): withstands up to 400 J
 - Impact test with a tennis ball: withstands up to a ball speed of 180 kph



Environmental qualities

- **The Acoustiroc® panel is made of recyclable materials:**
 - The steel and aluminum can be recycled indefinitely without altering their qualities. Steel is the most recycled material in the world, while recycled aluminum meets nearly 40% of worldwide demand.
 - Mineral wool is recyclable, and the vast majority of production waste is recycled. 45% of the wool content in Acoustiroc® panels is recycled.

A range of contemporary colors for totally customized projects!

Current trends have inspired 3 color palettes that are right on trend. From the most timeless to the most vibrant colors, these 12 tones will sublimate your creations.

All these moods can be coordinated to create the most varied stylistic effects. Monochrome walls, touches of vibrant color in a neutral setting, or alternating colors, vary the means to find the perfect and unique combination for your projects.

The Essentials for an Urban style

- Contemporary, urban and industrial tones
- A graphic range of timeless grays, from the lightest to the darkest



The Essentials

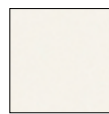

**BLANC PUR
(RAL 9010)**



**BLANC
ARCTIQUE**



**GRIS
ARGENT**



**GRIS
ASPHALTE**

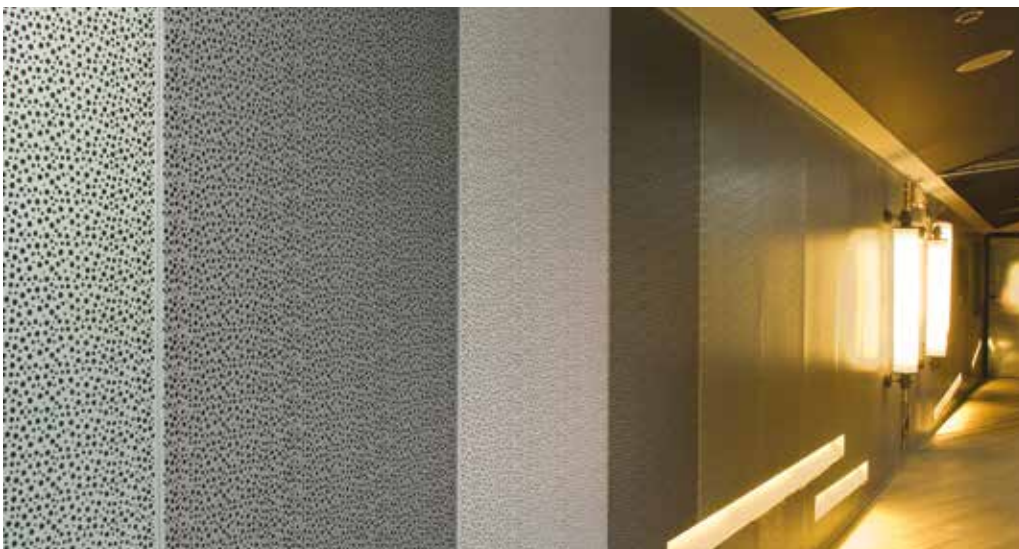

The Minerals for a Chic & Elegant spirit

- 3 warm tones and 1 cool tone
- Powdery colors for a classic and high-end atmosphere



The Minerals



SABLE
QUARTZ



ORANGE
CUIVRÉ



ROUGE
BRIQUE



BLEU
AZURITE



The Tonics for a Vibrant atmosphere

- A balanced range with invigorating, vivid and stimulating accents
- Colors right on trend, youthfulness, playful, and eccentric



The Tonics



BLEU
DRAGÉE



VERT
ANIS



JAUNE
D'OR



ORANGE
VERMILLON

The +

- The **"Soft Touch" finish** adds a high-end touch and feel to these colors specifically selected by Plafometal.

This matt textured finish adds warmth to the metal by creating depth.

It applies to all colors, except for Blanc Pur and Vert Anis.

Non-contractual colors.

The finish may vary depending on the perforations.

Contact your sales advisor to see a sample.

Acoustiroc®

Acoustic metal wall panel system made of perforated painted metal panels filled in with acoustic fleece and mineral wool, framed by aluminum profiles.



Acoustics

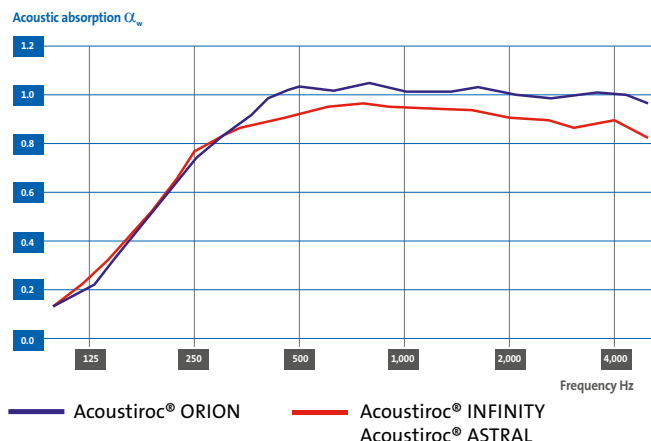

Perforations

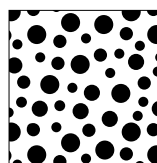

Acoustiroc® ORION
25% Ø3 to 7
(round, irregular)
 $\alpha_w = 1$
NRC : 0,95

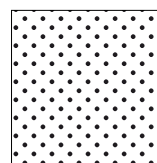

Acoustiroc® INFINITY
11% Ø1,5
(round, regular)
 $\alpha_w = 0,95$
NRC : 0,90

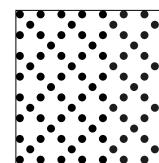

Acoustiroc® ASTRAL
17% Ø2,5
(round, regular)
 $\alpha_w = 0,95$
NRC : 0,90

As the perforation is continuous over the height, these perforations are randomly aligned from one panel to the next; this does not interfere with the overall visual rendering once the panels have been installed.



Fire reaction

■ A2-s1, d0 rating



Impact resistance

- The Acoustiroc® panels have been tested according to standard NF P 08-301.
- Soft body impact test (50 kg bag): withstands up to 400 J
- Tennis ball impact test: withstands up to a ball speed of 180 kph



Environment and health

Environment

The aluminum and steel are indefinitely and 100% recyclable. Mineral wool is recyclable and the vast majority of the production scrap is recycled. The results of a life cycle analysis (LCA) of the Acoustiroc® panel are available on our web site. Please contact us for more information.

Health

Stone wool panels are manufactured with fibers exempt from the carcinogenic classification (European Regulation 1272/2008 as amended by European Regulation 790/2009). This exemption is certified by the European Certification Board (EUCB - www.euceb.org). According to the International Agency for Research on Cancer, mineral wool is not classifiable as to its carcinogenicity to humans (Group 3).

Indoor Air Quality

Acoustiroc® is rated A and finnish label M1.

Colors

The Essentials



BLANC PUR
(RAL 9010)



* **BLANC**
ARCTIQUE



* **GRIS**
ARGENT



* **GRIS**
ASPHALTE

The Minerals



* **SABLE**
QUARTZ



* **ORANGE**
CUIVRE



ROUGE
BRIQUE



* **BLEU**
AZURITE

The Tonics



BLEU
DRAGÉE



VERT
ANIS



JAUNE
D'OR



ORANGE
VERMILLON

* Metallic paint

The "Soft Touch" finish is applied to all colors except Blanc Pur and Vert Anis.



Maintenance and cleaning

- By their very nature, our metal panel requires little cleaning.
- They can be cleaned in a number of ways, please refer to the installation instructions available at www.plafometal.com
 - Never use abrasive products.
 - For use in wet rooms: contact us.





Module dimensions

Width	790 mm
Height*	2,700 mm
Panel thickness	40 mm
Steel thickness	0.8 mm

*Height between 2100 and 3900 mm on request

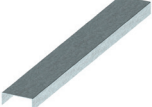
Practical packaging in a kit

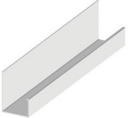
Acoustiroc® system components

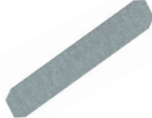
	Description <i>Dimensions</i>	Quantity	Packaging	
	Acoustiroc® panel 790x2,700x40 mm	Depends on configuration	Package no. 1.1 (Panels)	2 panels per package
	Wedge 13x38x13 Length 1,580 mm	0.5 per panel	Package no. 1.2 (Panel installation kit)	1 wedge per package
	Clip for vertical installation	1 to 2 per join		4 clips per package
	Clip for horizontal installation	3 per pannel		6 clips per package
	Aluminum profile 65x46x30 Length 2,800 mm	Depends on configuration	Depends on configuration	6 profiles per package
	Angle connector	4 per frame		6 units per package
	Straight connector	Depends on configurations		6 units per package

Package no. 1.1

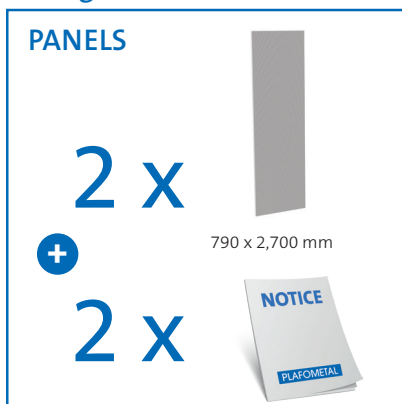

Package no. 1.2

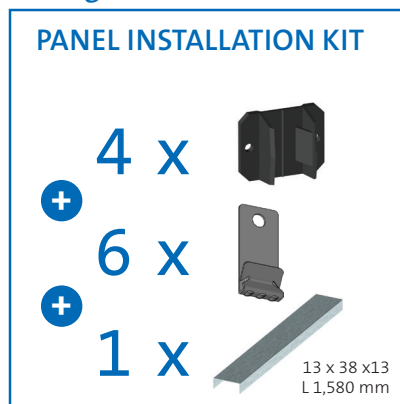

Package no. 2

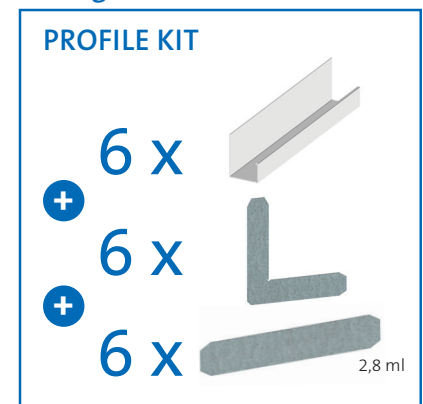

Packages 1.1 and 1.2 are inseparable

Different installation options for more aesthetic choices

Vertical installation

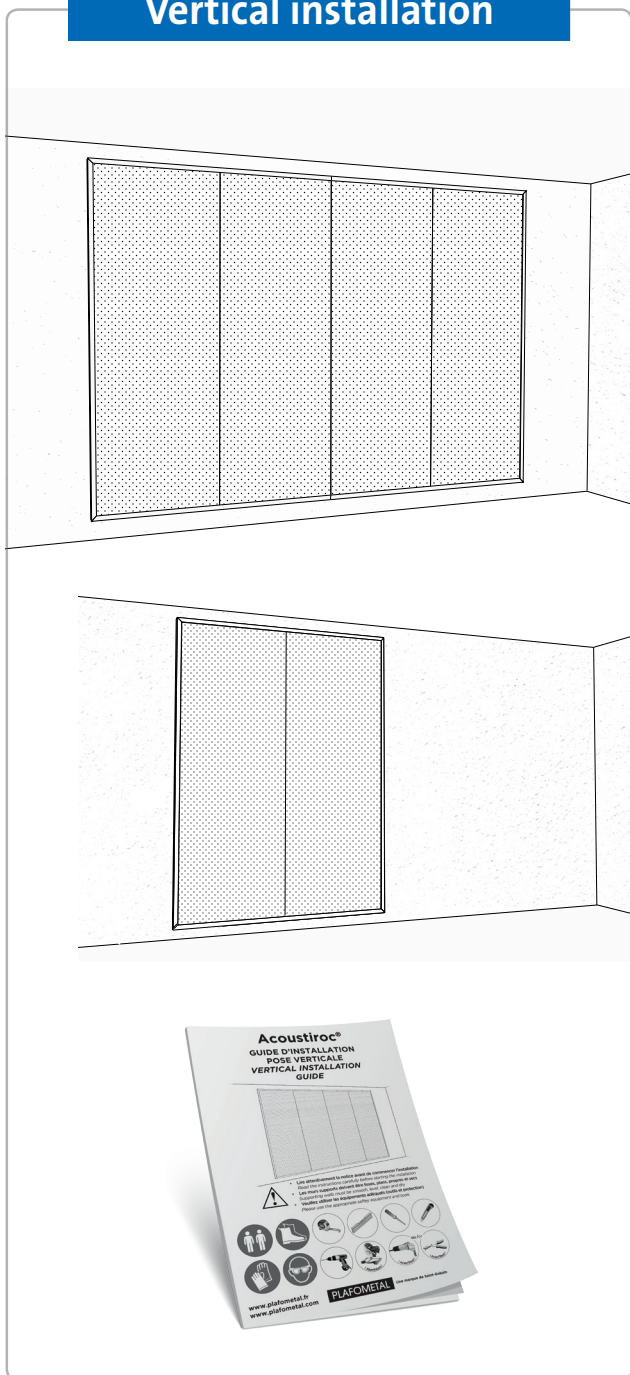

Horizontal installation

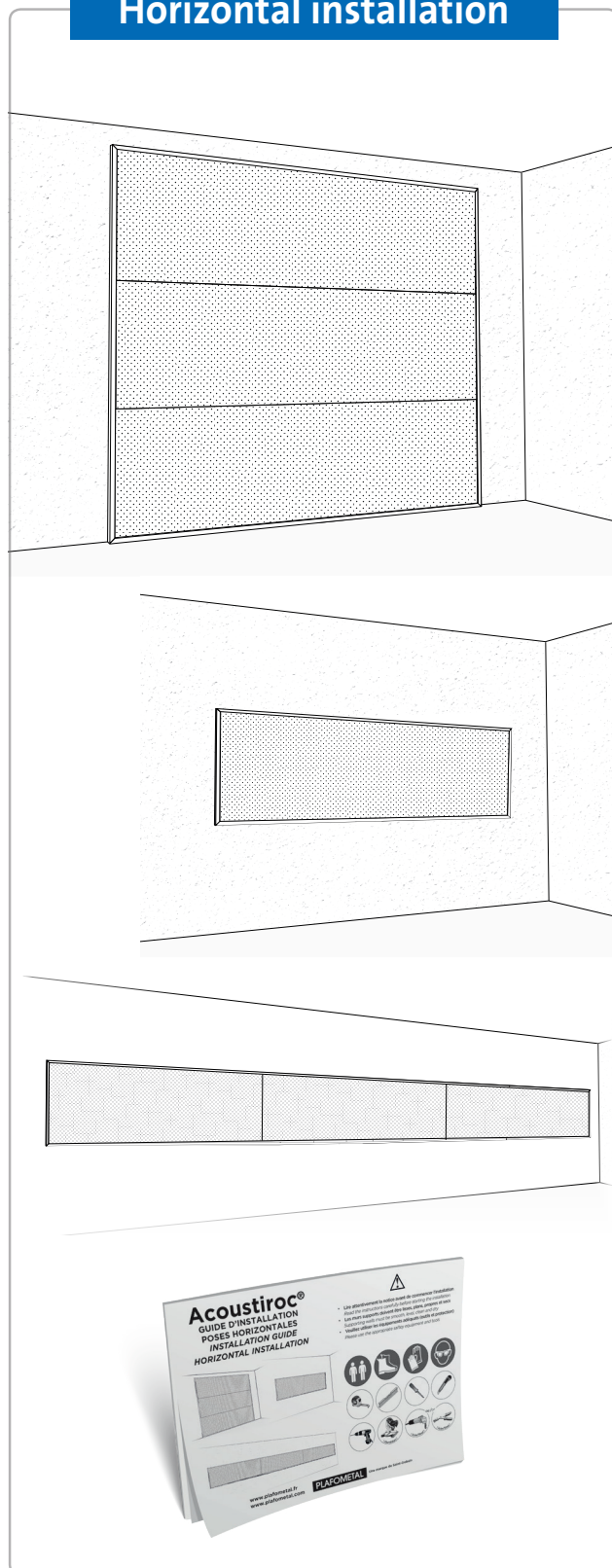

- Easy to install in just a few steps
- Refer to the available installation instructions on www.plafometal.com and in paper version in each package
- Easy to clean at the end of the job and during product life

Swift and efficient logistics!

2 offers meeting all needs

- Easy to order
 - Small quantities (Minimum order: 1 package = 2 panels)
- Conditions valid in metropolitan France and while stocks last



Standard offer

- **Color:** 12 selected Plafometal colors
- **Dimensions:** 2,700x790x40mm
- **3 perforations:** Acoustiroc® Orion, Acoustiroc® Infinity or Acoustiroc® Astral
- **Lead time:**
 - 2 to 3 weeks for Blanc Pur (White - RAL 9010)
 - 3 to 4 weeks for the 11 other colors in the range
- **Terms of delivery:** Contact us
- **Minimum quantity:** 1 package (2 panels)

Other colors and heights to order

- **Color:** Powder coating to order in the RAL color chart
- **Dimensions:** Height to order $2.1\text{m} \leq H \leq 3.9\text{m}$
- **3 perforations:** Acoustiroc® Orion, Acoustiroc® Infinity ou Acoustiroc® Astral
- **Lead time:** Contact us
- **Minimum quantity:** 1 pallet (8 packages) - contact us

The Essentials

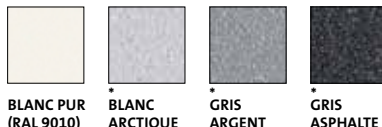

The Minerals

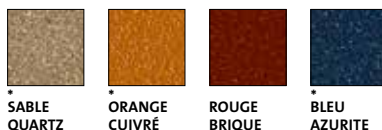

The Tonics



* Metallic paint
The "Soft Touch" finish is applied to all colors except Blanc Pur and Vert Anis.



CUSTOMER SERVICE

+33 (0)3 24 59 54 18



Find
your sales contacts
on our website
www.plafometal.com

This brochure supersedes all previous brochures. This document is provided for guidance only, and Plafometal reserves the right to modify the information in this brochure at any time. Plafometal makes no warranties that the information in this brochure is exhaustive or free of material errors. Plafometal shall not be held liable if the products and systems presented in this brochure are used and/or installed other than in accordance with the rules specified herein and all applicable codes of practice, technical recommendations, standards and best practices. The results of the classification test reports featured in this brochure have been obtained under standardized test conditions. This brochure contains references to trademarks protected by industrial property rights. Each element contained in this brochure (including texts, photos, images, illustrations and diagrams) is protected under intellectual property law. These elements are not legally binding. Similarly, the diagrams in this brochure do not constitute legally binding working drawings. Any reproduction of this brochure, whether in whole or in part, or of any one of the elements herein on any storage medium whatsoever is prohibited without prior written authorization from Plafometal.

Plafometal - Simplified joint-stock company with capital of €200,960 - Incorporated in the Trade and Companies Register of Sedan under no. 423 933 779 - Route de Phades, 08800 Monthermé, France. Photo credits: Plafometal, Pascal Artur, Franck Deletang, Adobe Stock, Fotolia. October 2020. This brochure may not be reproduced or sold. Actual products may vary from the photos and illustrations in this brochure. Do not litter.

A Saint-Gobain brand

PLAFOMETAL